

diami.

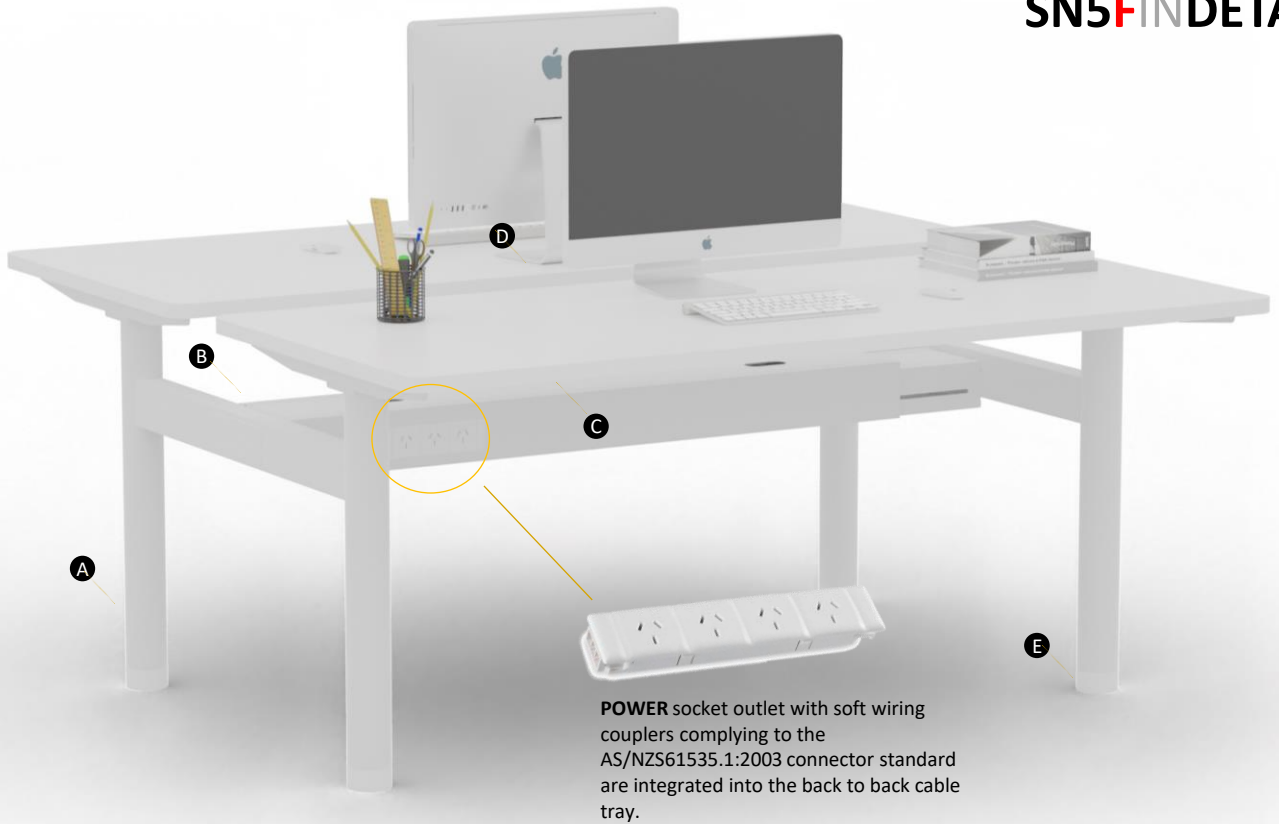

**SN5F**  
Fixed Height



- A. Sturdy 70mm Round profile upright
- B. Telescopic cable tidy tray (on back to back desk)
- C. Scratch resistant worktop with 120kgs load rating

- D. Cable access cut out
- E. Floor levers



### Single desk

750mm Deep  
1500/1600/1800/2100 – mm  
Width



### Back to back desk

750mm Deep  
1500/1600/1800/2100 – mm  
Width



### PET Screen

750mm Deep  
1500/1600/1800/2100 – mm  
Width

### Frame powder coat finish

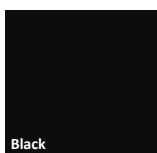

### Worktop finish (other finishes are available)

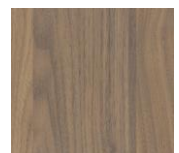
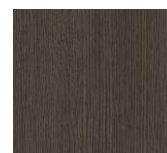
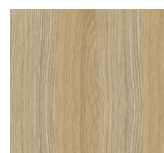
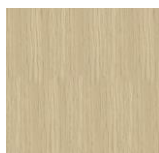
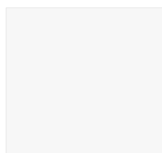

# SN5FSCREEN



## Full fabric spine screen

1250mm High with 450mm airgap  
1500/1600/1800/2100mm Wide  
\*fixed shared screen

## OXO Screen

1250mm High with 450mm airgap  
1500/1600/1800/2100mm Wide  
\*fixed shared screen

## PET wrap around desk screen

480mm above desk  
1500/1600/1800/2100\*mm Wide -  
- 300mm returns – or custom (\*Join)



## Perspex dividers

380mm above desk  
750 – mm Width  
- Smokey White finish

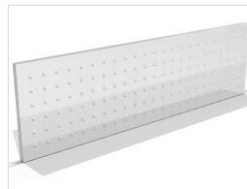

## Underdesk modesty panel

350mm High  
1200 / 1400 – mm Width  
– White or Black PC



## Screen toppers - Perspex

150mm High  
1500/1600/1800/2100 – mm  
Width – or Custom

## SLIMLINE 111 30mm PANEL SYSTEM



### A. Spine screen

(Slimline111)

- 1250mm High with 450mm airgap x 1500/1600/1800/2100mm Wide
- Full fabric with alloy frame

### B. Divider screen

(Slimline111 solid)

- 1250mm High x 750/900/1200mm Wide
- Full fabric to the floor

### C. End screen

(Slimline111 solid)

- 620mm High x 750mm Wide
- Full fabric or melamine



Evolve range: (other fabrics are available) | PET range : Contact your sales consultant.



# ACCESSORIES



## Under top Power/DATA

950/1550/1750mm Wide  
- 4GPO / 4GPO + 2DATA



## Desk top power rail

1GPO/2GPO/4GPO  
2USB-AA / 2USB-AC



## In desk power module

1GPO only or with:  
2USB-AA / 2USB-AC / Keystone  
- White / Black



## Wireless charger

80mm Dia – 15W pad  
- White / Black



## Single LCD arm

Code: QA-S (Gas assisted)  
-White / Black



## Dual LCD arm

Code: QA-D (Gas assisted)  
-White / Black



## Underdesk CPU holder

Vertical slide and rotate  
-White / Back



## Linear LED lighting

Ceiling mounted  
1500/1600/1800/2100  
-White / Black

## About Diami.

Diami is an Australian owned wholesale manufacturing business that has been designing and producing quality commercial furnishing products since 1995.

Operating out of Sydney, diami is one of Australia's largest suppliers of seating products to the Corporate, Government, Education, Architectural & design markets through a network of dealers and sales offices throughout Australia and New Zealand.

At diami we believe that a work environment influences the way we feel, so we have made it our mission to ensure that our furniture inspires, motivates and stimulates while offering complete user comfort, performance and good health. We have a dynamic approach to furniture design delivering uplifting environments and happy places to work. We are a modern active company and are proud of our products and role in society.



FS 623709 EMS 623711

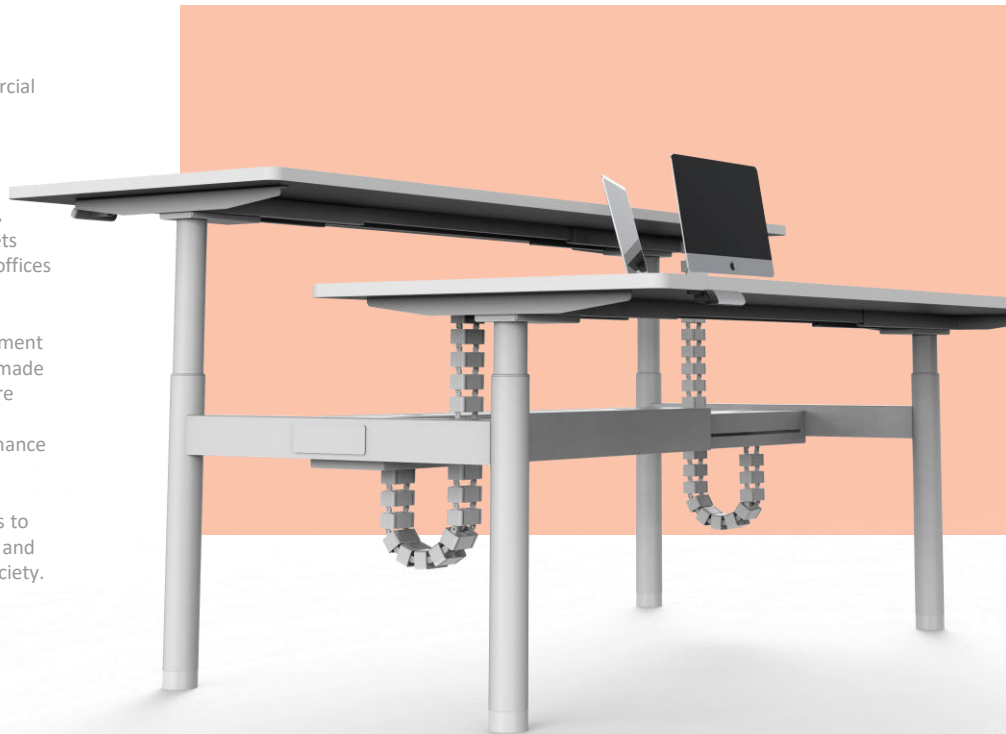

**\*Electric version also available**