

The Members of
FURSIS GROUP



FURSIS

iloom

SIDIZ



T40 Series

User Guide



 FURSIS

www.globalfursys.com

2017 REV. 0

 FURSIS



FURSYS Story

Number one commercial furniture export sales company in Korea

FURSYS is Korea's leading furniture brand with the largest sales volume of office furniture in Korea and the number 1 in overseas exports. In addition to Korean companies, the world's leading companies use FURSYS furniture. You can experience FURSYS products in your home as well as the office.

Recognized worldwide for its design and quality excellence

FURSYS has won numerous awards, at home and abroad. It is the first Korean company to be awarded the world's top three design awards (RED DOT, IDEA, IF). FURSYS pursue diversification of design through its in-house Research & Development center and collaboration with famous designers from abroad.

Certified with eco-friendly products

FURSYS has been recognized for its commitment to green management by acquiring GreenGuard certification, the global green certification system for all products.

T402

T40 User Guide

- 01 Height adjustment
- 02 Tilting angle adjustment
- 03 Tilting tension adjustment
- 04 Seat depth adjustment
- 05 Armrest adjustment
- 06-1 Headrest adjustment
- 06-2 Lumbar adjustment

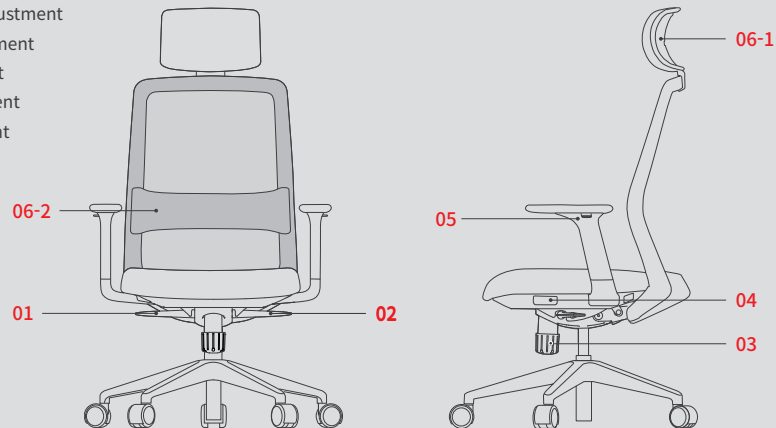

01

Adjusting the height of seat

When elevating the height of seat, lift up the lever then release it at the height desired. When lowering the height of seat, sit on the center of the chair then lift up the lever, release it at the desired height.

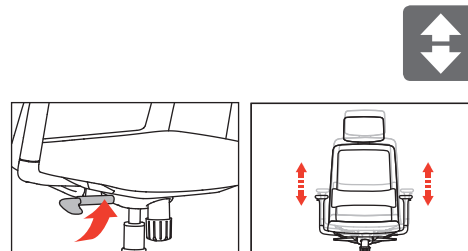

02

Adjusting the backrest tilting

Pull the left lever to the desired angle to be tilted to enable individual setting. Snap the lever back to its original position to recline all the way back.

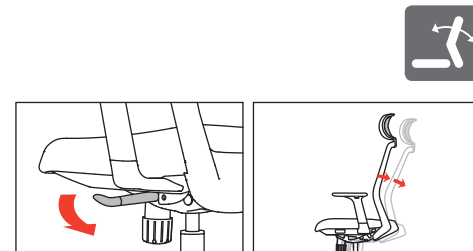

03

Adjusting the strength of tilting

While sitting rotate the handle clockwise then the strength of tilting will be weaker and if rotate the handle counter-clockwise, the strength will be stronger.

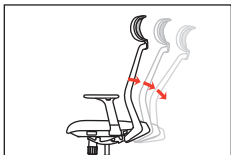
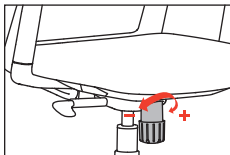

04

Adjusting the depth of seat

Push the button located on lower left side of seat then pull out the front side of seat then you will be able to use 5-Step depth adjusting function for your convenience.

*When adjusting the depth of seat, please do it when standing up.

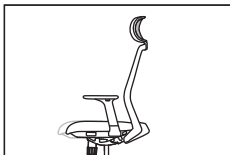
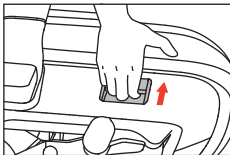

05

Adjusting the armrest

| Armrest height | Push the button located on the lower side of left/right arm pad and adjust the height of armrest.

| Armrest angle | To adjust angle of armpad, grab the armpad and move it to the direction you want it to be.

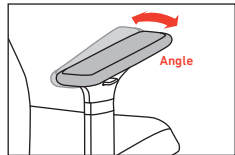
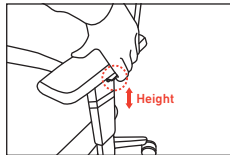

06

Adjusting the headrest / lumbar support

| Headrest | Grab the headrest using both hands, fix it at the desired height.

| Lumbar support | You can adjust the lumbar both up and down to fit your body.



The headrest and the lumbar support is detachable.

